

FLK125 In-Line Cartridge Filters

Working Pressures to: 508 psi
3505 kPa
35.1 bar

Rated Static Burst to: 2000 psi
13,790 kPa
138 bar

Flow Range To: 85 gpm
322 lpm

Applications

- Hydrostatic Charge Pumps
- Hydrostatic Transmission
- Pilot Control Circuits



NOTE:

Lubricate filter-to-head threads when installing new filter to prevent thread damage.
Heavyweight gear lube is recommended.

Features

The FLK assembly is a robust, reusable housing and disposable cartridge design. The versatile FLK filter head accommodates multiple housing lengths. Industrial, raised hand grips make it easy to remove the housing from the head without the need for special servicing tools. The oil drain port on the bottom of the housing and the locking grab handles on the filter cartridge allow for cleaner, easier servicing. The filter tabs lock into place – simplifying positioning during reassembly. Short removal clearance is needed for filter replacement means the assembly can easily fit into tight spaces.

These assemblies utilize a unique sealing technology that protects systems from harmful ingressed contaminants and cross contamination of oil. The RadialSeal™ interface increases the surface area which provides a robust connection with superior vibration resistance, a common challenge in today's heavy-duty applications.

The FLK filters are offered with Synteq XP™ media, Donaldson's most advanced media technology. Each filter has extended surface area for advanced filtration performance. Synteq XP delivers better pressure drop and better contaminant holding capacity than standard filter media.

- Robust 4-point mount
- Oil drain port
- Optional 2-point mount
- Heads features: - one side machined/plugged for indicator

Beta Rating

- Performance to $\beta_{<6(c)} = 1000$

Porting Size Options

- 2" SAE 4 bolt flange code 61

Replacement Filter Lengths

- 10.85" / 275.7 mm

Standard Bypass Ratings

- 50 psi / 345 kPa / 3.5 bar

Assembly Weight

- Long Housing: 4.76 kg / 10.50 lbs

Operating Temperatures

- -40° to 250°F (-40° to 121°C)

Filter Collapse Ratings

- 145 psid / 1000 kPa / 10 bar (standard)



FLK125
Max Flow: 85 gpm (322 lpm)

FLK Specification Illustrations

Long Assembly - Side View

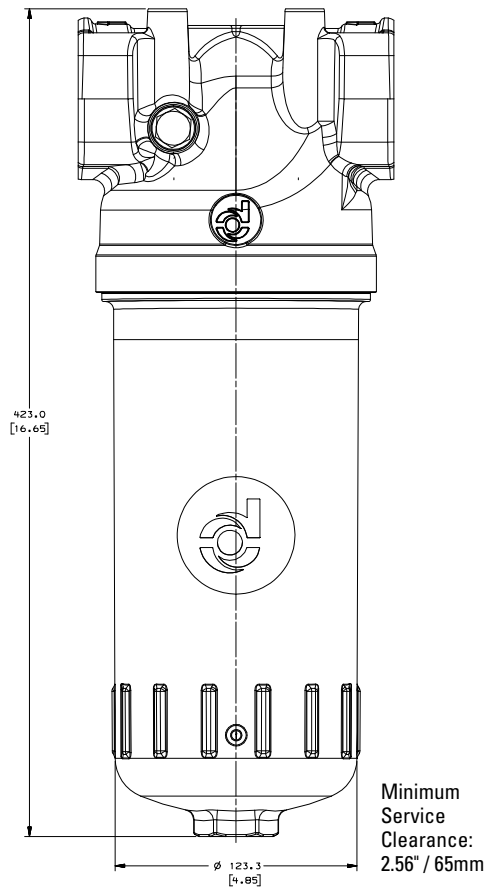

Head - Top View

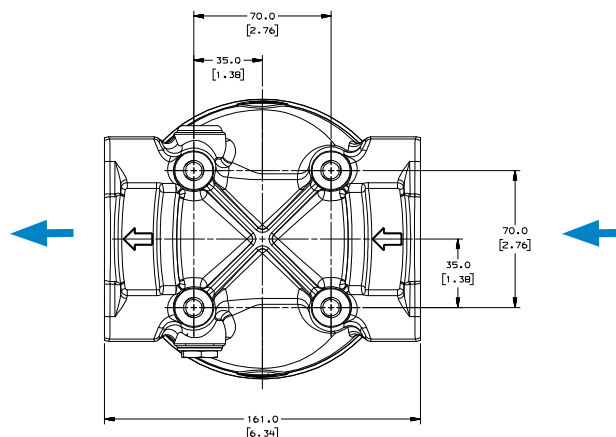

FLK125 Components

Head Choices

Part No.	Port Connections	Bypass Valve
P767095	2" SAE 4 bolt	50 psi (3.4 bar) bypass

Housing Choices

Part No.	Comments
P767089	Long length assembly

Filter Choices

Media	$\beta_{x(c)} = 1000$	Length		Donaldson
Type	Rating based on ISO 16889	in	mm	Part No.
Synteq XP	6 μ m	10.85	275.7	P767084
Synthetic	11 μ m	10.85	275.7	P767104
	15 μ m	10.85	275.7	P767106

Service Indicator Choices

Use with Bypass	Indicator		
Valve Pressure of:	Part No.	Style ²	Description
Electric Models ¹			
50 psi / 345 kPa	P165194	A	Single post DC. N.O.
50 psi / 345 kPa	P574968	B	DC 2-wire
50 psi / 345 kPa	P574967	E	DC 2-wire
50 psi / 345 kPa	P575549	F	DC 3-wire
50 psi / 345 kPa	P174396	C	AC/DC 3-wire
25 psi / 172.5 kPa	P575334	H	Visual pop up
50 psi / 345 kPa	P575335	H	Visual pop up

Indicator Notes

¹All electric models have a maximum operating temperature of 250°F / 121°C.

²Complete details on all service indicators can be found in the accessories section.

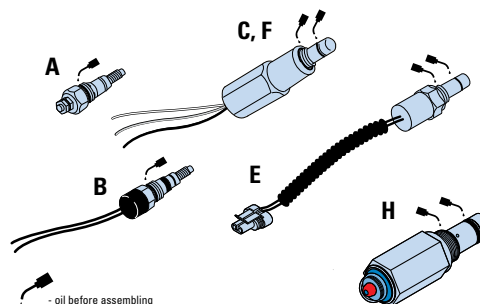

Performance Data

FLK125 Housing Only

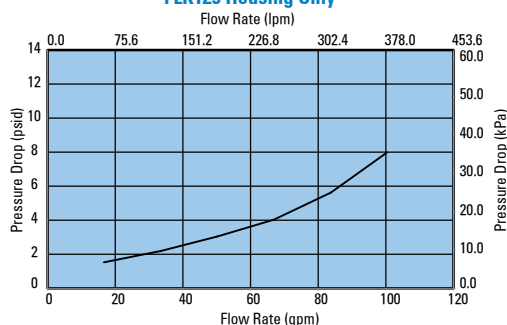

FLK125 Filter only
(Synthetic Media, 10.43"/265mm)

