



FPK02

Max Flow: 25 gpm (95 lpm)



FPK02 In-Line Cartridge Filters

Working Pressures to: 6090 psi
42,021 kPa
420 bar

Rated Static Burst to: 9135 psi
63,000 kPa
630 bar

Flow Range To: 25 gpm
95 lpm



Features

The FPK02 is built to withstand pressures of over 6000 psi (420 bar). It features a cast iron head and cold-extruded steel housing for ultimate strength and durability. This filter meets the HF2 in-plant automotive specification.

Bypass options include 87 psi/6 bar bypass, bypass with reverse-flow check valve, or no bypass.

Take advantage of our mix and match system of in-stock heads, housings and cartridges, so you can get exactly what you need. You can also choose the media type and configuration that's best for your application. All FPK02 filters contain Synteq™, Donaldson's exclusive synthetic fiber media formulated especially for hydraulic filtration.

Beta Rating

- Performance to $\beta_{<4(c)} = 1000$

Porting Size Options

- SAE-12 O-ring

Replacement Filter Lengths

- 4.41" / 111.9mm
- 4.46" / 113.2mm
- 8.16" / 207.2mm
- 8.28" / 210.3mm

Operating Temperatures

- -20°F to 250°F / -29°C to 120°C

Standard Bypass Ratings

- 87 psi / 600 kPa / 6 bar
- 87 psi Bypass with reverse-flow check valve
- No Bypass

Assembly Weight

- 4.41" Assembly: 9.2 lbs / 4.2 kg
- 8.28" Assembly: 13.2 lbs / 6.0 kg

Filter Collapse Ratings

- 290 psi / 2000 kPa / 20 bar (standard)
- 3000 psi / 20,700 kPa / 207 bar (high collapse)

FPK02 Specification Illustrations

All dimensions are shown in inches [millimeters].

Assembly - Side View

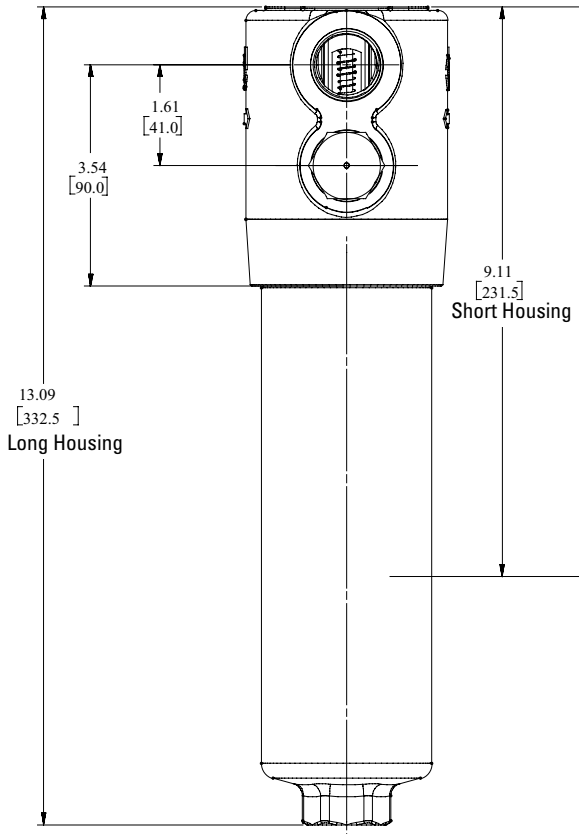

Applications

- High Pressure Circuits
- In-Plant Systems
- Meets HF2 Specification
- Mobile Equipment
- Power Steering Circuits
- Servo Valve Circuits

Head - Top View

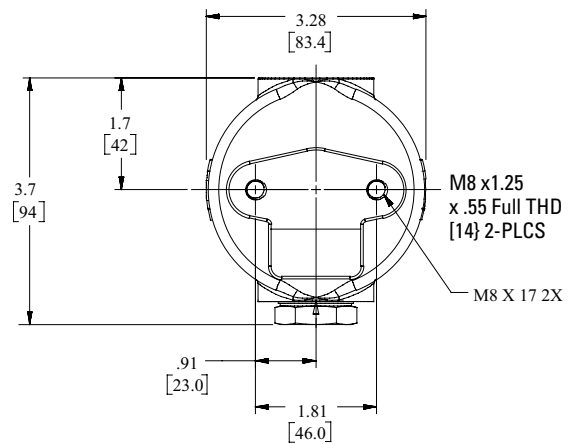

Head - Side View

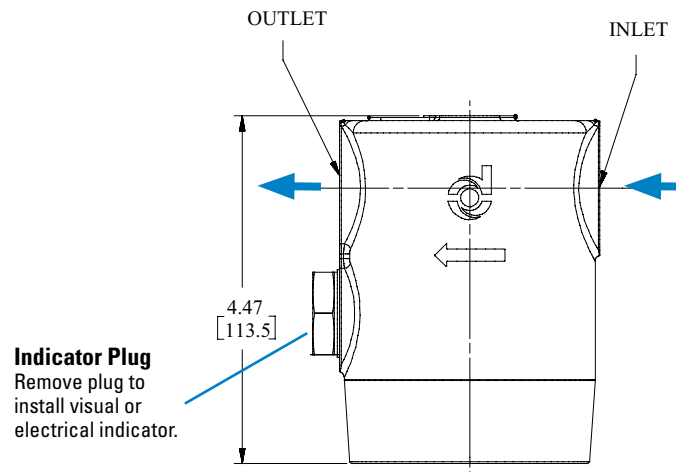

All dimensions above are shown in inches [millimeters]



FPK02
Max Flow: 25 gpm (95 lpm)

FPK02 Components

High-Performance DT Filter Choices

Media Type	$\beta_{x(c)} = 1000$ Rating based on ISO 16889	Length		Donaldson Part No.	Comments
		in	mm		
DT Synteq Synthetic	<4 μm	4.41	112	P566194	DT-9020-4-2UM
	5 μm	4.41	112	P566195	DT-9020-4-5UM
	8 μm	4.41	112	P566196	DT-9020-4-8UM
	12 μm	4.41	112	P566197	DT-9020-4-14UM
	23 μm	4.41	112	P566198	DT-9020-4-25UM
	<4 μm	8.28	210	P566199	DT-9020-8-2UM
	5 μm	8.28	210	P566200	DT-9020-8-5UM
	8 μm	8.28	210	P566201	DT-9020-8-8UM
	12 μm	8.28	210	P566202	DT-9020-8-14UM
	23 μm	8.28	210	P566203	DT-9020-8-25UM
	5 μm	4.46	113	P566335	DT-9021-4-5UM, High collapse
	12 μm	4.46	113	P566336	DT-9021-4-14UM, High collapse
	5 μm	8.16	207	P566337	DT-9021-8-5UM, High collapse
	12 μm	8.16	207	P566338	DT-9021-8-14UM, High collapse

Filter Notes

All Donaldson DT filters utilize glass fiber media with an epoxy-based resin system for the ultimate in chemical compatibility. All Donaldson DT filters are potted with epoxy-based adhesives. Standard collapse DT designs are double wire-backed using epoxy-coated steel mesh for maximum pleat support and dirt capacity. High collapse designs are double wire-backed using stainless steel mesh. High collapse designs are also potted into machined aluminum endcaps for greater filter integrity in critical applications. Viton® seals are standard on all Donaldson DT filters. Viton® is a registered trademark of E. I. DuPont de Nemours and Company.



Housing Choices

Length (in.)	Part No.
4.4" filter	P762769
8.2" filter	P762770

Head Choices

Port Size	Bypass Rating	Part No.
SAE-12 O-Ring	87 psi / 6 bar	P762766
SAE-12 O-Ring with reverse-flow check valve	87 psi / 6 bar	P762767
SAE-12 O-Ring	No Bypass	P762768

NOTE: Indicator port is machined and plugged. Replace plug with indicator of choice: P171945 (visual) or P761056 (electrical).

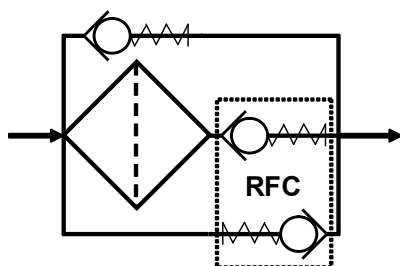

Reverse Flow Check Schematic

Standard Filter Choices

Media Type	$\beta_{x(c)} = 1000$ Rating based on ISO 16889	Length		Donaldson Part No.	Comments
		in	mm		
Synteq Synthetic	5 μm	4.37	111	P167180*	Fluorocarbon Seal, High Collapse
	5 μm	8.12	203	P167182*	Fluorocarbon Seal, High Collapse
	6 μm	4.37	111	P165041	Buna-N Seal
	6 μm	8.12	203	P165043	Buna-N Seal
	11 μm	4.37	111	P165006	Buna-N Seal
	11 μm	8.12	203	P165015	Buna-N Seal
	12 μm	4.37	111	P167181*	Fluorocarbon Seal, High Collapse
	12 μm	8.12	203	P167183*	Fluorocarbon Seal, High Collapse
	23 μm	4.37	111	P165136	Buna-N Seal
	23 μm	8.12	203	P165138	Buna-N Seal

Filter Notes

*Utilizes DT Synteq synthetic media

Refer to the table in the Technical Reference Guide for fluid compatibility with our filter media.

If you're filtering petroleum-based oil, filters with seals made of Buna-N are appropriate for most applications.

If you're filtering diester, phosphate ester fluids, water glycol, water/oil emulsions, and HWCF over 150°F/83°C, use filters with seals made of fluorocarbon, such as Viton® from DuPont Dow Elastomers, or Fluorel® from 3M Company.

Donaldson "high collapse" filters, with their steel end caps and wire-backed media, are rated to withstand up to 3000 psi/ 20,700 kPa before collapsing.

The fluorocarbon seal/high collapse filters also use epoxy potting and media seam seals for added chemical compatibility.

Viton® and Buna-N® registered trademarks of E. I. DuPont de Nemours and Company.





Performance Data

FPK02 Housing Only

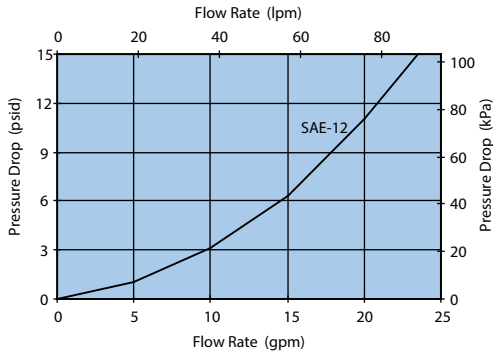

FPK02 Standard 4" Filter Only

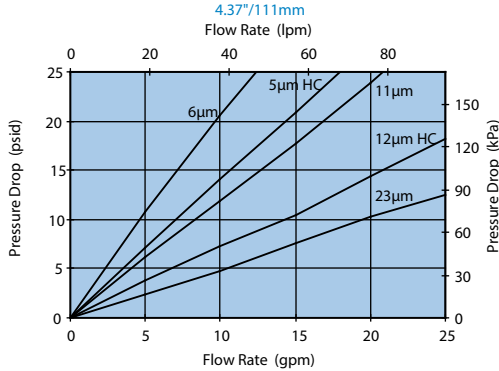

FPK02 Standard 8" Filter Only

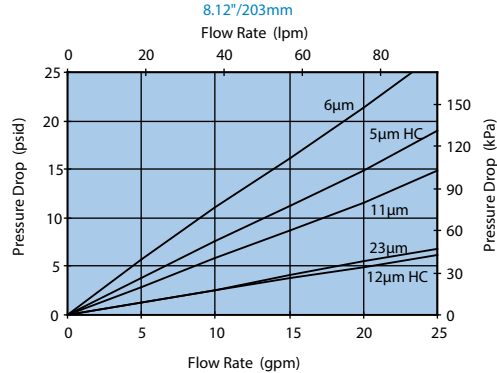

FPK02 4" DT Filter Only

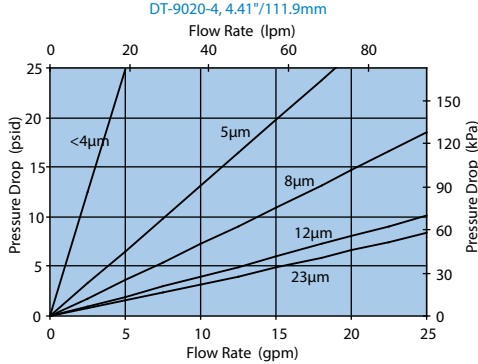

FPK02 8" DT Filter Only

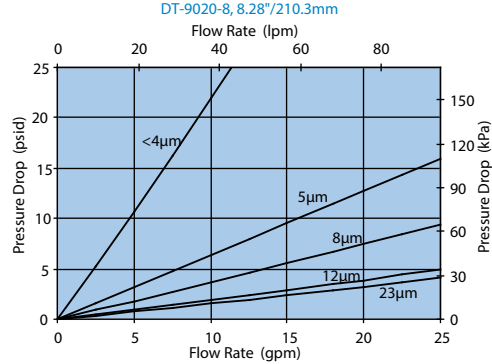

FPK02 4" DT Filter Only

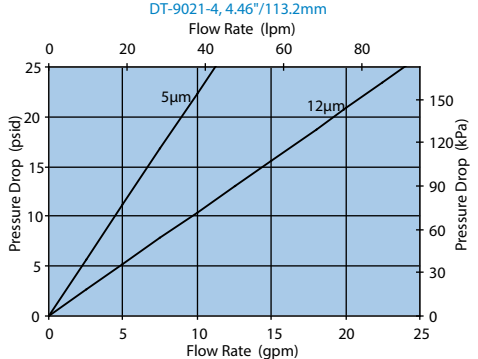

FPK02 8" DT Filter Only

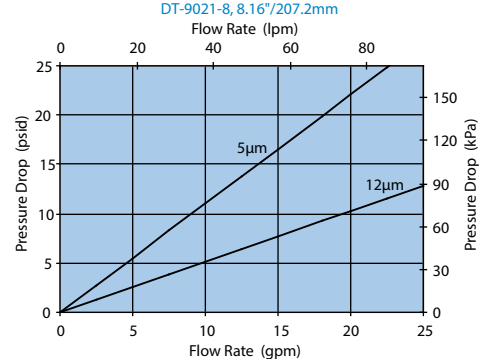

FPK02 Service Parts

When installing the FPK02 housing onto an installed head, torque it to 15 ft-lbs./2.1 kg-m.

SERVICE PARTS NOTE:

Some service parts may not be stocked. Please contact your Donaldson sales representative for lead time details.

