

Chelsea® 272/282 Series

PowerShift PTO – Air or Hydraulic
for Mechanical or Automatic Transmissions



Overview:

Power density is what you will find in the New Chelsea 272 Series PTO. This series is designed with a compact housing that helps eliminate clearance issues. High capacity bearings and superior gear designs support torque ratings up to 300 lbs-ft for ultimate performance. There is no need to de-rate the PTO for continuous duty applications. The robust design of this PTO transmits all the power you will need. It features eighteen shift options, twelve of which are integrated into the PTO housing. The hoses are included with the PTO for simplified ordering. Our popular Electronic Overspeed Control (EOC) is also available to protect your driven equipment. Nine internal gear ratios offer a wide variety of speeds to meet your application requirements. The direct mount pump flange options are available with our Wet Spline design that provides you with the confidence of increased PTO and pump shaft life.

NOTE: The 272 replaces the 230/231, 236 and 270/271. The 282 replaces the 238.

- LP Gas Trucks
- Water Trucks
- Tow and Recovery
- Service Trucks
- Dump Trucks
- Aerial Trucks



Contact Information:

Parker Hannifin Corporation
Chelsea Products Division
8225 Hacks Cross Road
Olive Branch, MS 38654 USA

Phone: 1-888-PH4-TRUK
(1-888-744-8785)

Fax: 1-662-895-1069
chelseacustserv@parker.com

www.parker.com/chelsea

Product Features and Benefits:

- SAE 6-Bolt housing – 272
- Low profile SAE 6-Bolt housing – 272M
- SAE 8-Bolt housing – 282
- Air or Hydraulic Shift Options
- Integrated Air Valve – No remote valve (patent pending)
- Shaft Brake – Internal self-adjusting (patent 7159701)
- Wet Spline Option – Extends PTO and pump shaft life
- Pressure lubrication – Extends PTO service life
- Electronic Overspeed Control – Protects driven equipment
- Single Duty Torque Rating – Continuous duty
- Smart Start Option – Reduces high inertia startup
- Two Year Warranty



ENGINEERING YOUR SUCCESS.

272/282 SERIES POWER TAKE-OFF SPECIFICATIONS AND TECHNICAL DATA

272 272 X B FN P - B 5 X D										
Basic Model			Output Option							
272			Driveline Output							
282			XD = Rd Standard Shaft (1-1/4" - 5/16" Key)							
			XV = 1410 Series Companion Flange							
			BD = Drag Brake - Rd Standard Shaft (1-1/4" - 5/16" Key)							
			BV = Drag Brake - 1410 Series Companion Flange							
			⁶⁴ SD = Smart Start - Rd Standard Shaft (1-1/4" - 5/16" Key)							
			⁶⁴ SV = Smart Start - 1410 Series Companion Flange							
			AB = DIN 120 Flange							
			AC = DIN 100 Flange							
			Pump Mount							
			RE = Rotatable SAE "A" 2-Bolt Flange, SAE "A" Shaft (5/8" - 9T)							
			RB = Rotatable SAE "B" 4-Bolt Flange, SAE "B" Shaft (7/8" - 13T)							
			RK = Rotatable SAE "B" 2 or 4-Bolt Flange, SAE "B" Shaft (7/8" - 13T)							
			RF = Rotatable SAE "B" 2 or 4-Bolt Flange, SAE "BB" Shaft (1" - 15T)							
			RZ = Rotatable SAE "B" 2 or 4-Bolt Flange, SAE "C" Shaft (1-1/4" - 14T)							
			RS = Rotatable SAE "C" 2 or 4-Bolt Flange, SAE "C" Shaft (1-1/4" - 14T)							
			RY = Rotatable ISO 7653 Flange, DIN 5462 Shaft							
			XR = Chelsea Special (Cloverleaf), SAE "B" Shaft (7/8" - 13T)							
			Assembly Arrangement							
			3 = Right side - bulge down							
			Left side - bulge up							
			5 = Left side - bulge down							
			Right side - bulge up							
			Shift Option							
			Hydraulic							
			B = 12V Elec/Hyd - Integral							
			D = 24V Elec/Hyd - Integral							
			E = 12V Elec/Hyd w/o Installation Kit - Integral							
			N = 24V Elec/Hyd w/o Installation Kit - Integral							
			K = 12V Elec/Hyd w/ EOC							
			L = 24V Elec/Hyd w/ EOC							
			G = 12V Elec/Hyd Remote Valve w/o EOC							
			H = 24V Elec/Hyd Remote Valve w/o EOC							
			Air							
			A = Manual Air Shift							
			V = Manual Air Shift w/o Installation Kit							
			1 = 12V Elec/Air - Integral							
			2 = 24V Elec/Air - Integral							
			J = 12V Elec/Air w/ EOC - Integral							
			3 = 24V Elec/Air w/ EOC - Integral							
			P = 12V Elec/Air Remote							
			Q = 24V Elec/Air Remote							
			R = 12V Elec/Air Remote w/ EOC							
			4 = 24V Elec/Air Remote w/ EOC							
Mounting Option										
272/282										
X = Standard Mount										
Z = Deep Mount										
G = Metric Stud Kit										
K = Standard Mount w/o Stud Kit										
272 Only										
L = Deep Mount w/o Stud Kit										
M = Low-Profile w/ Standard Stud Kit										
N = Low-Profile w/ Metric Stud Kit										
A = Aisin Only (Non-Dodge/Ram)										
D = Dodge/Aisin										
R = RAM/Aisin										
282 Only										
E = EATON Fuller Mount (Brazil)										
Gear Ratio										
272 Only										
A = 19/53										
272/282										
B = 22/50										
C = 25/47										
D = 28/44										
G = 31/41										
K = 33/39										
M = 35/37										
P = 37/35										
S = 39/33										
282 Only										
T = 41/31										
Input Gear Designator										
Aisin, Allison, EATON Fuller, and Mack										
NOTE: For more details, see Application Catalog.										
(Transmission Model Number required.)										
Lube Option										
X = No Pressure Lube										
Pressure										
P = Pressure Lube										
⁵ R = Valve Cap Rotated 120°										
⁵ S = Valve Cap Rotated 240°										
Wet Spline										
⁵ W = Wet Spline										
⁵ V = Valve Cap Rotated 120° w/ Wet Spline										
⁵ Y = Valve Cap Rotated 240° w/ Wet Spline										

⁵ Automatically pressure lubed

⁶⁴ Hyd shift PTOs only

Approximate Weight: 49 lbs. [22 kg]										
Specifications Chart	272*A	272*B 282*B	272*C 282*C	272*D 282*D	272*G 282*G	272*K 282*K	272*M 282*M	272*P 282*P	272*S 282*S	282*T
Intermittent & Continuous Torque Rating lbs-ft [Nm]	300 [407]	300 [407]	300 [407]	300 [407]	300 [407]	300 [407]	300 [407]	300 [407]	300 [407]	300 [407]
HP Rating for Intermittent & Continuous Service										
At 500 RPM of Output Shaft HP [Kw]	29 [21]	29 [21]	29 [21]	29 [21]	29 [21]	29 [21]	29 [21]	29 [21]	29 [21]	29 [21]
At 1000 RPM of Output Shaft HP [Kw]	57 [43]	57 [43]	57 [43]	57 [43]	57 [43]	57 [43]	57 [43]	57 [43]	57 [43]	57 [43]

272/272M/282 SERIES HOUSING DIMENSIONS

272 Series

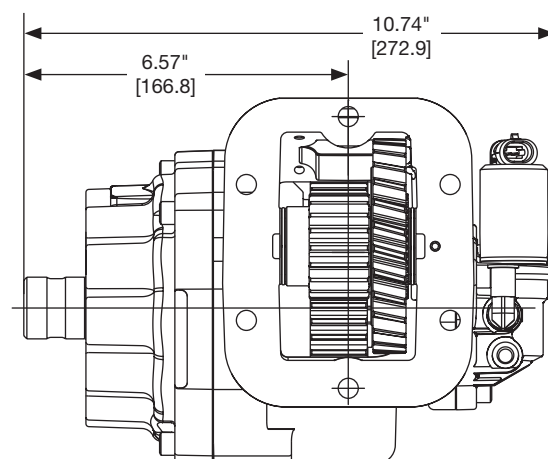
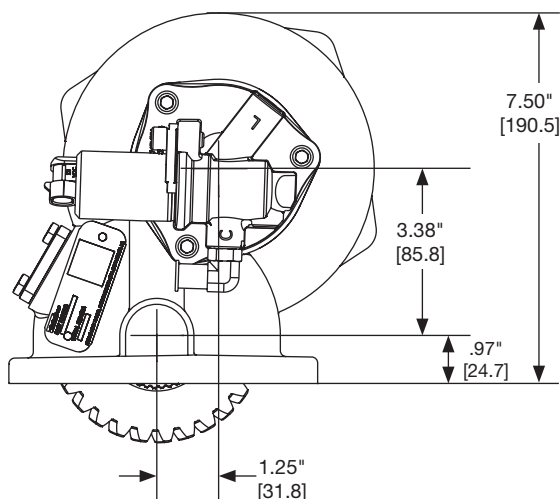

272M Series

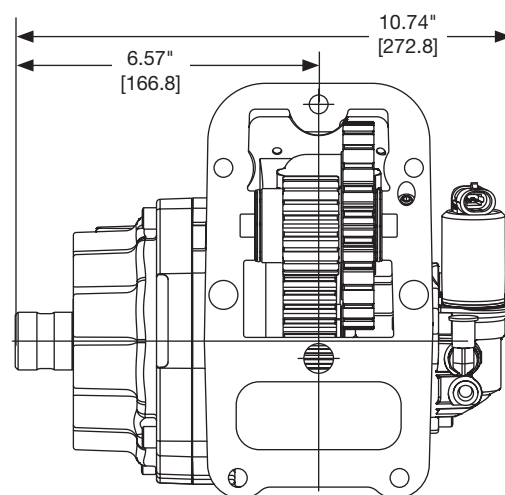
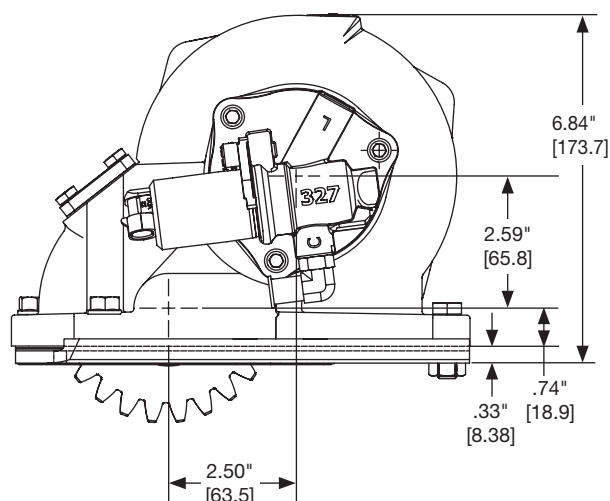

282 Series

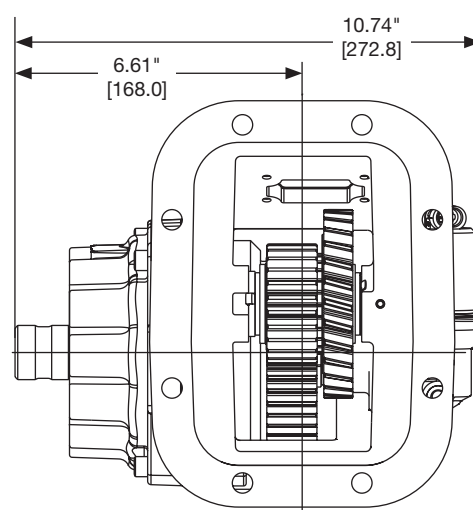
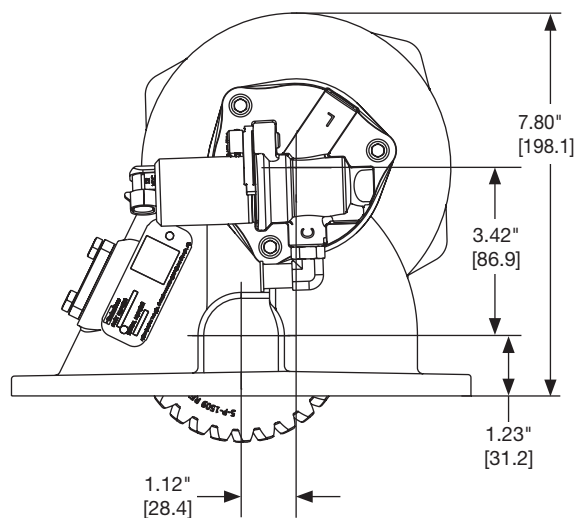

ENGINEERING YOUR SUCCESS.

ASSEMBLY ARRANGEMENTS

272 Series

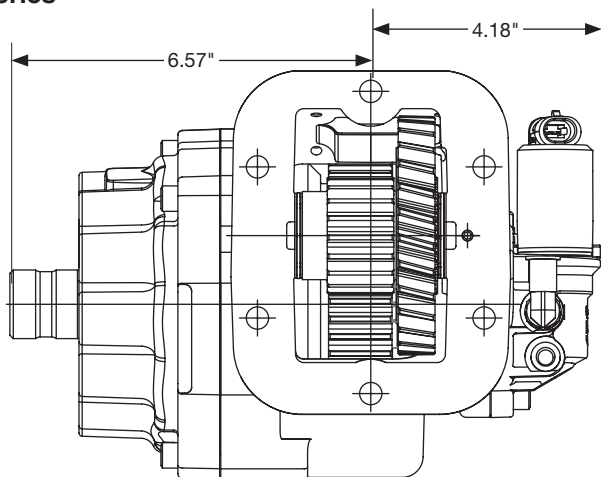

"5" Arrangement

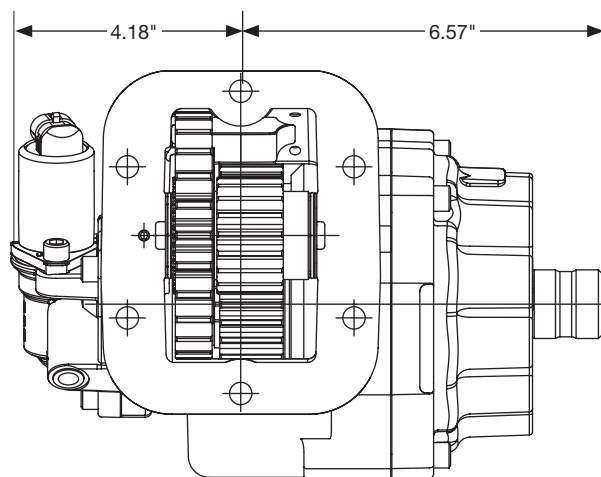

"3" Arrangement

272M Series

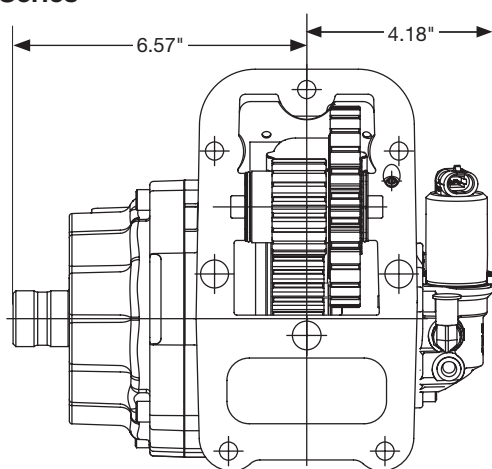

"5" Arrangement

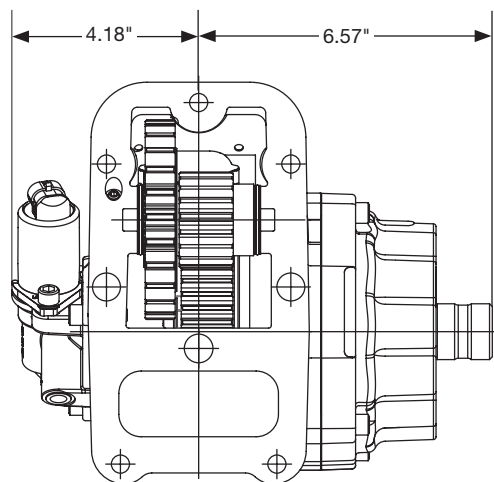

"3" Arrangement

282 Series

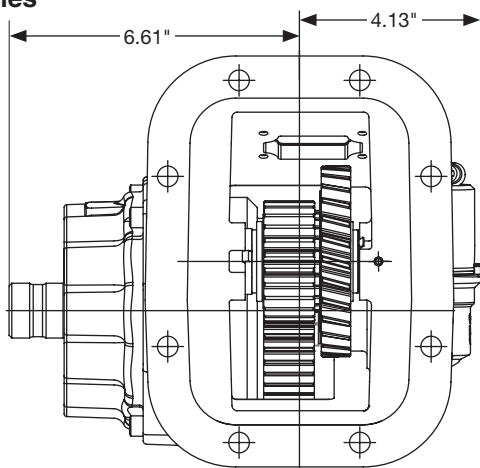

"5" Arrangement

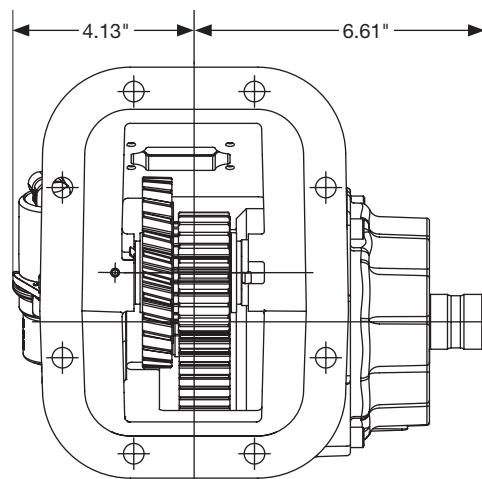

"3" Arrangement