

Chelsea® 272-FORD Series

FORD TorqShift® 6 Transmission for the
F650/750



Overview:

The Chelsea 272F Series PTO features all the robust power density of the 272 specifically designed for the FORD 6R140 TorqShift® 6 transmission on the F650/750 chassis. High capacity bearings and superior gear design provide torque ratings up to 300 ft-lbs*. The superior design of the 272-FORD allows you to take full advantage of all the power available on the transmission with 6.8L gas or 6.7L diesel engines. There are multiple ratios, output types, and shift options to make it a versatile PTO for the F650/750. It is available with Electronic Overspeed Control (EOC) and SmartStart options to protect your equipment and extend the life of your truck, there by maximizing work and profits. It can be used in both Mobile or Stationary modes. The 272-FORD is the best PTO choice for your FORD truck.

*See Chelsea Application Catalog for details.

- Tow & Recovery
- LP Gas
- Water Trucks
- Service Trucks
- Aerial
- Dump
- Refuse

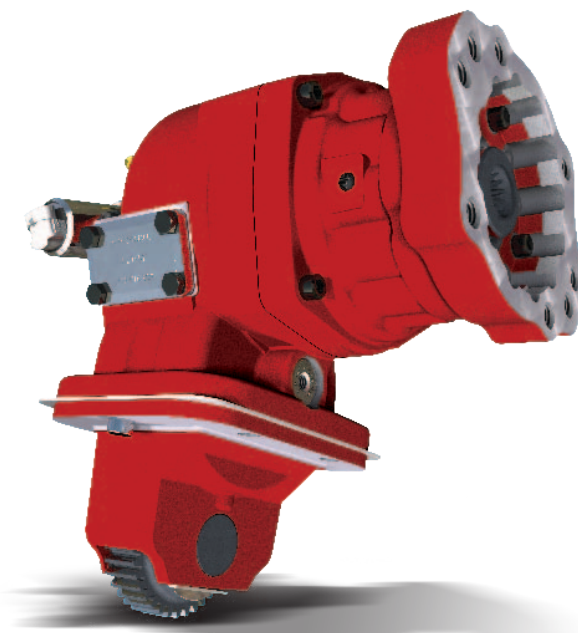

Contact Information:

Parker Hannifin Corporation
Chelsea Products Division
8225 Hacks Cross Road
Olive Branch, MS 38654 USA

Phone: 1-888-PH4-TRUK
(1-888-744-8785)

Fax: 1-662-895-1069
chelseacustserv@parker.com

www.parker.com/chelsea

Product Features and Benefits:

- **Torque** – Ratings up to 300 lbs-ft.*
- **Clearance** – Interference issues have been reduced with compact housing.
- **Positive Stop** – Driveline outputs; eliminates oil seal damage from coupling.
- **Speeds** – Multiple speeds available.
- **Shift** – Three options.
- **Smart Start Available** – Shock load dampening feature to protect driven equipment.



ENGINEERING YOUR SUCCESS.

272 SERIES POWER TAKE-OFF SPECIFICATIONS AND TECHNICAL DATA

272	F	B	LL	P	-	B	8	XD
Basic Model								
272								
Mounting Option								
J = MY2012-MY2015 F650/F750 6.8L Gas H = MY2016+ F650/F750 6.8L Gas F = MY2016+ F650/F750 6.7L Diesel								
Gear Ratio								
C = 25/47 D = 28/44 G = 31/41 K = 33/39 M = 35/37 P = 37/35 S = 39/33								
Input Option								
LL - FORD 6R140 TorqShift® 6 NOTE: For more details, see Application Catalog								
Lube Option								
Pressure P = Pressure Lube								
Output Option								
Driveline Output								
XD = Rd Standard Shaft (1-1/4" - 5/16" Key) XV = 1410 Series Companion Flange SD = Smart Start - Rd Standard Shaft (1-1/4" - 5/16" Key) SV = Smart Start - 1410 Series Companion Flange								
Pump Mount								
RE = Rotatable SAE B 4-Bolt Flange, SAE BB Shaft (1" - 15T) RB = Rotatable SAE B 4-Bolt Flange, SAE B Shaft (7/8" - 13T) RK = Rotatable SAE B 2 or 4-Bolt Flange, SAE B Shaft (7/8" - 13T) RF = Rotatable SAE B 2 or 4-Bolt Flange, SAE BB Shaft (1" - 15T) RZ = Rotatable SAE B 2 or 4-Bolt Flange, SAE C Shaft (1-1/4" - 14T) RS = Rotatable SAE C 2 or 4-Bolt Flange, SAE C Shaft (1-1/4" - 14T) RY = Rotatable ISO 7653 Pump Mounting DIN 5462 Shaft XR = Chelsea Special (Cloverleaf), SAE B Shaft (7/8" - 13T)								
Assembly Arrangement								
8 = Left Side - no offset								
Shift Option								
Hydraulic								
B = 12V Elec/Hyd E = 12V Elec/Hyd w/o Installation Kit K = 12V Elec/Hyd w/ EOC								

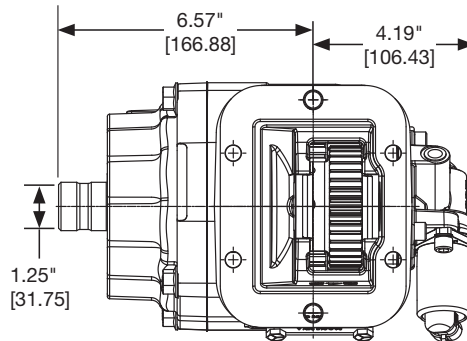
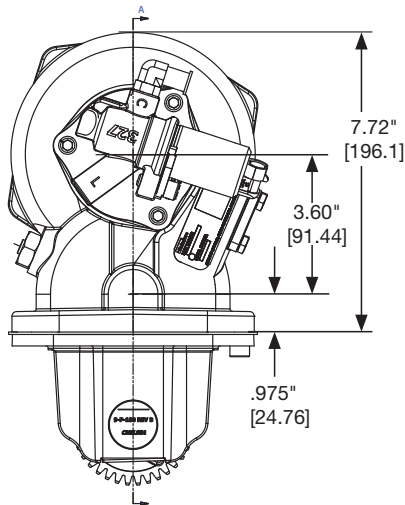

Specifications Chart

Approximate Weight: 55 lbs. [25 kg]

	272*CLL	272*DLL	272*GLL	272*KLL	272*MLL	272*PLL	272*SLL
Intermittent Torque Rating lbs-ft [Nm]	300 [407]	300 [407]	300 [407]	300 [407]	274 [371]	246 [333]	220 [298]
HP Rating for Intermittent Duty							
At 500 RPM of Output Shaft HP [Kw]	29 [21]	29 [21]	29 [21]	29 [21]	26 [19]	23 [17]	21 [16]
At 1000 RPM of Output Shaft HP [Kw]	57 [43]	57 [43]	57 [43]	57 [43]	52 [39]	47 [35]	42 [31]

* Ford limits the 6R140 transmission to 60 HP for Diesel Engine and 40 HP for Gas Engine applications.

© 2017 Parker Hannifin Corporation

Supersedes HY25-0193-B1/US June 2017 HY25-0193-B1/US August 2017



ENGINEERING YOUR SUCCESS.