

Parts List			
ITEM	QTY	PART NUMBER	DESCRIPTION
1	1	57XL-40	40 Micron FILL w/30 Mesh Stainless Strainer
2	1	APP0750-M	3/4" NPT MAG PLUG
3	1	APP1250	1 1/4" NPT SQUARE SOCKET PLUG
4	1	APP2000	2" NPT SQUARE SOCKET PLUG
5	1	N_A3300BE	NAM WELDMENT 24W20H14.75D ~ 86.8 lbs
6	1	T-LLG-5	SIGHT/TEMP. GAUGE, 5"

NOTES:  
 -POWDER COAT BLACK  
 -APPLY RUST INHIBITOR INSIDE  
 -PLUG ALL PORTS FOR SHIPMENT

WT: ~89.05 lbs

<b>AMERICAN MOBILE POWER</b> PH: (800) 634-8265 FAX: (765) 948-3403	DRAWING BY: BPKNIGHT	DESIGN FOR: AMP	FILE NAME: A3300BE	
	COMPLETED: 11/6/2013		SHEET: 1 of 7	SHEET SIZE: B

4

3

2

1

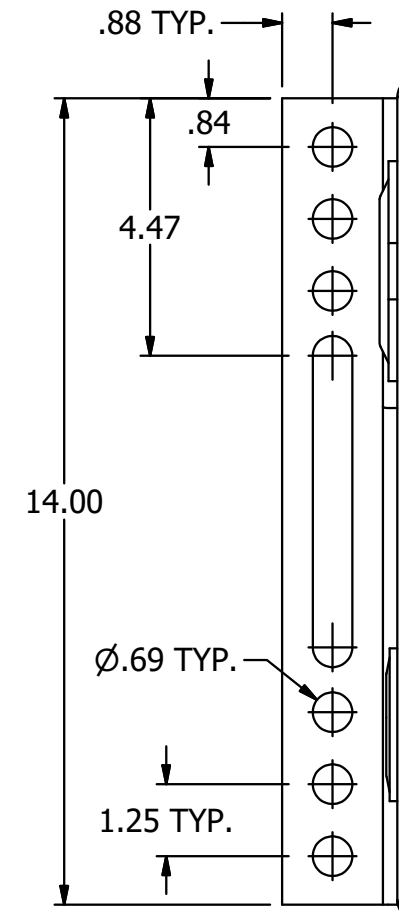
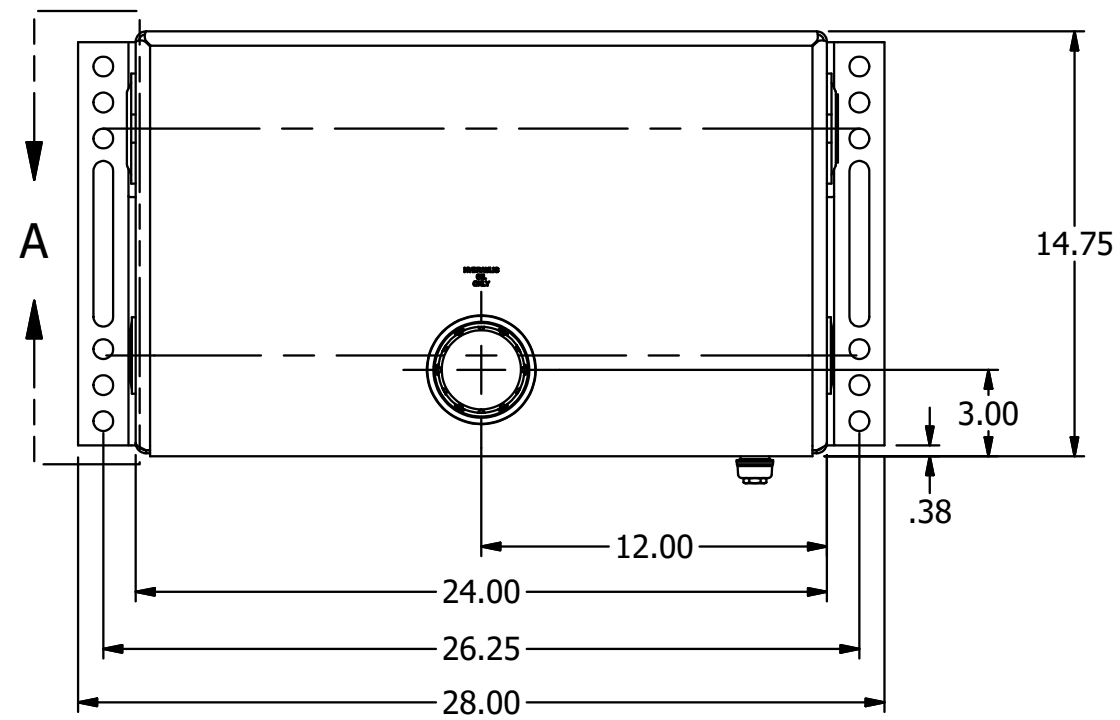

DETAIL A

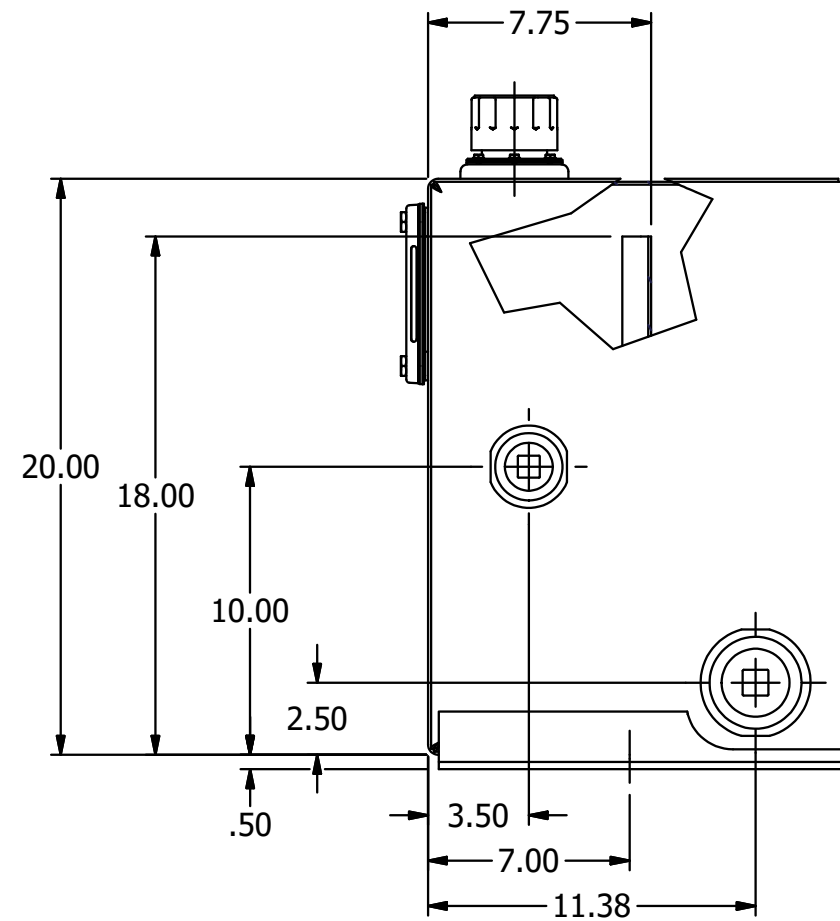
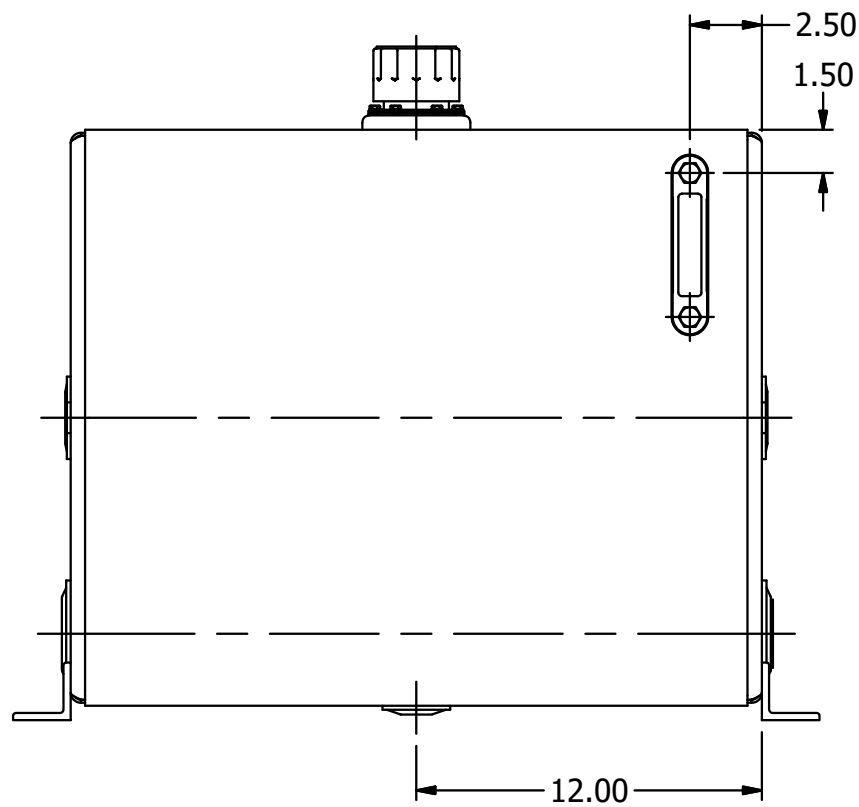

**AMERICAN  
MOBILE POWER**

PH: (800) 634-8265 FAX: (765) 948-3403

DRAWING BY:  
BPKNIGHT

COMPLETED:  
11/6/2013

DESIGN FOR:  
AMP

FILE NAME:  
A3300BE

SHEET:  
2 of 7

SHEET SIZE:  
B

4

3

2

1

B

B

A

A

4

3

2

1

Parts List

ITEM	QTY	PART NUMBER	DESCRIPTION	Fab Qty
1	2	0500-13-FWN	1/2"-13 UNC WELD NUT	
2	1	A3300BF	12 GA HRPO BAFFLE	
3	1	A3300BS	12 GA HRPO SIDE-BACK-SIDE	
4	1	A3300FS	12 GA HRPO SIDE-FRONT-SIDE	
5	1	A3400BEAL	2 X 2 X 1/4" MFG ANGLE	
6	1	A3400BEAR	2 X 2 X 1/4" MFG ANGLE ALT.	
7	1	AFS-301	13 GA HRPO Fill Ass'y Weld Flange	
8	1	SWF0750	3/4" NPTF STEEL WELD FLANGE	
9	2	SWF1250	1 1/4" NPSC STEEL WELD FLANGE	
10	2	SWF2000	2" NPSC STEEL WELD FLANGE	

B

B

A

A

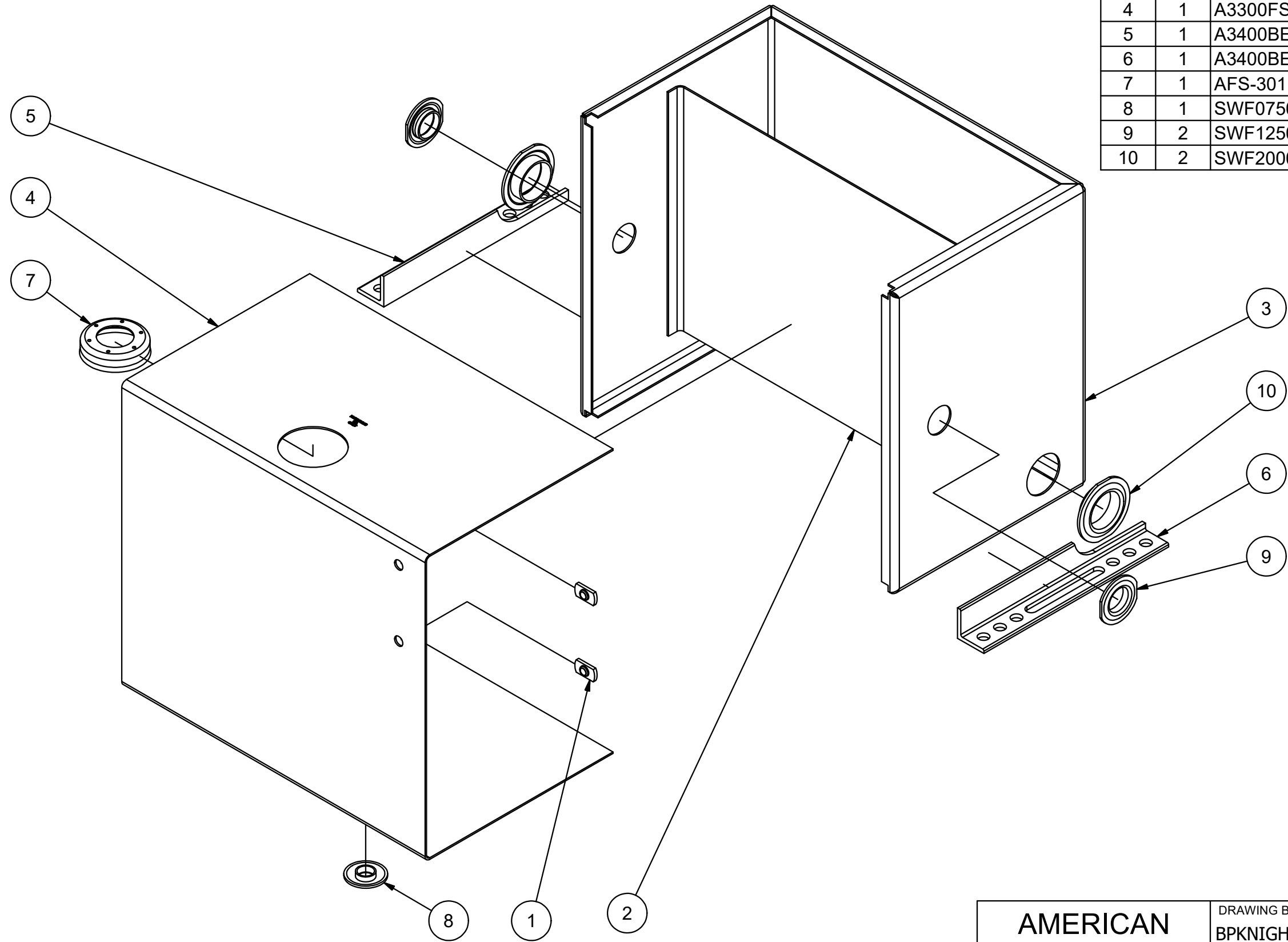

<b>AMERICAN MOBILE POWER</b> PH: (800) 634-8265 FAX: (765) 948-3403	DRAWING BY: <b>BPKNIGHT</b>	DESIGN FOR: <b>AMP</b>	FILE NAME: <b>A3300BE</b>	
	COMPLETED: <b>11/6/2013</b>		SHEET: <b>3 of 7</b>	SHEET SIZE: <b>B</b>

4

3

2

1