

PILOT OPERATED RELIEF VALVE

RF SERIES



FEATURES

- RF series relief valve is designed on the theory of differential pressure created by flow across the orifice of the balance piston. This differential pressure acts to open the piston against the spring, permitting enough fluid vented to tank at the set pressure.
- Piston moves smoothly, and controlled by pilot pressure, provides stable pressure control and good repeatability.

Symbol

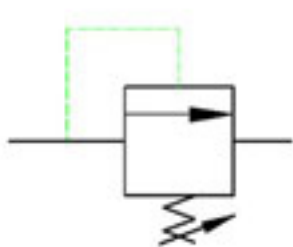

Model Code

RF - T 06 - 1 - ** - N

1

2

3

4

5

6

1 Series

RF: Relief Valve

2 Mounting Style

G: Subplate Mounted

T: Threaded Body

3 Size

04: 25 GPM

06: 50 GPM

10: 100 GPM

4 Pressure Adj. Range

1: 100-1000 PSI (7-69 BAR)

2: 500-2000 PSI (35-138 BAR)

3: 1000-3550 PSI (69-247 BAR)

5 Design Number

6 Ports

No Code: For "G" Subplate Style

N: NPT Ports for "T" Threaded Body Style

04: 1/2" NPT

06: 3/4" NPT

10: 1-1/4" NPT

S: SAE St. Thd. O-Ring Ports for "T" Threaded Body Style

04: 3/4 - 16 SAE

06: 1-1/16 - 12 SAE

10: 1-5/8 - 12 SAE

PILOT OPERATED RELIEF VALVE

RF SERIES

SPECIFICATIONS

MODEL	MAX. PRESSURE BAR (PSI)	PRESSURE ADJ. RANGE BAR (PSI)	MAX. FLOW LPM(GPM)	MOUNTING BOLTS (FOR G TYPE) MM(INCH)
RF-*04	245 (3550)	1:7-69(100-1000)	100 (25)	M12x70L(1/2"x2-3/4") 2PCS M12x90L(1/2"x3-1/2") 2PCS
RF-*06		2:35-138(500-2000)	200 (50)	M16x60L(5/8"x2-1/4") 2PCS M16x80L(5/8"x3-1/4") 2PCS
RF-*10		3:69-247(1000-3550)	400 (100)	M20x70L(3/4"x2-3/4") 2PCS M20x90L(3/4"x3-1/2") 2PCS

PERFORMANCE CURVES

TEST CONDITIONS

Viscosity: 35 cSt (175 SSU) Temperature: 50° C (122° F)

NOMINAL OVERRIDE

MIN. ADJ. PRESSURE

RF-G04, RF-T04

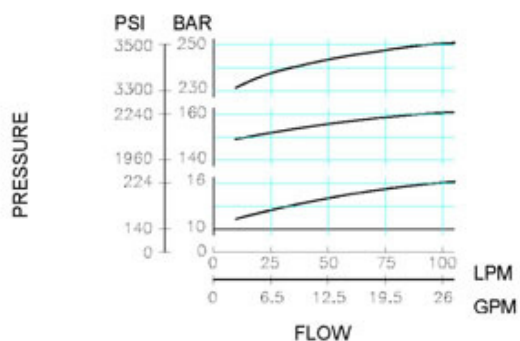

RF-G04, RF-T04

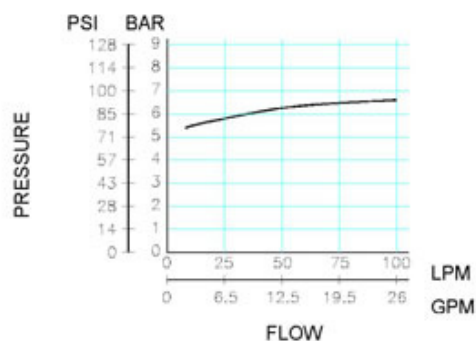

RF-G06, RF-T06

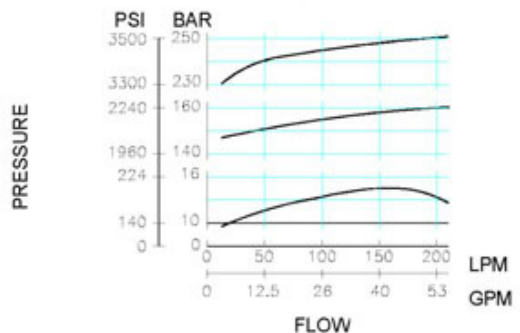

RF-G06, RF-T06

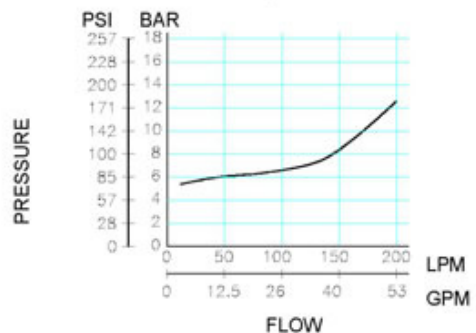

RF-G10, RF-T10

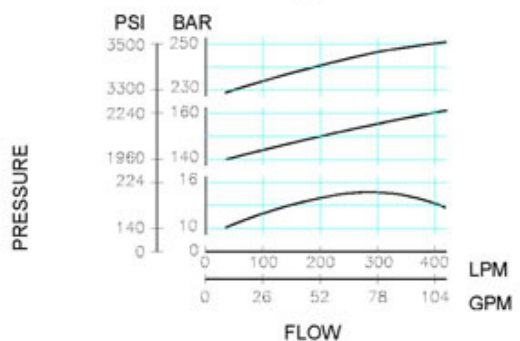

RF-G10, RF-T10

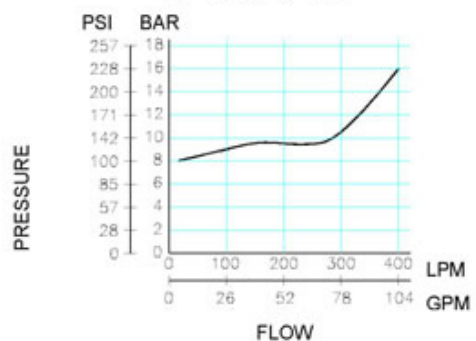

PILOT OPERATED RELIEF VALVE RF SERIES

DIMENSIONS

UNIT: mm(inch) WEIGHT: 1.5 kgs(3.4 lbs)

RFG-04

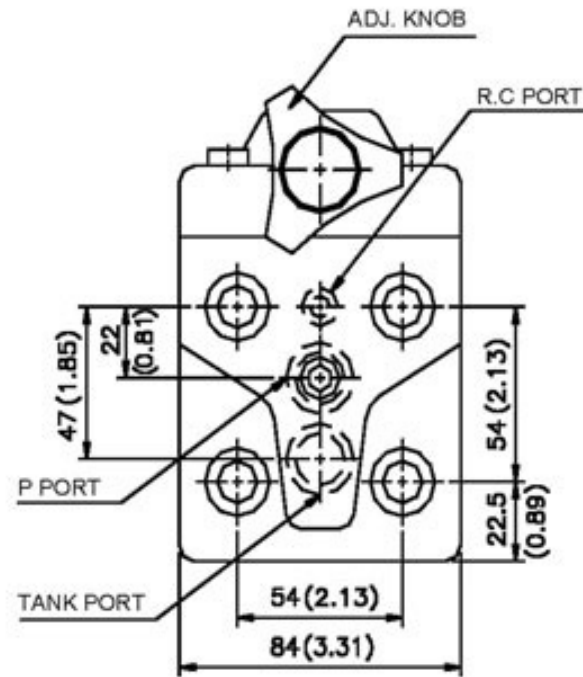
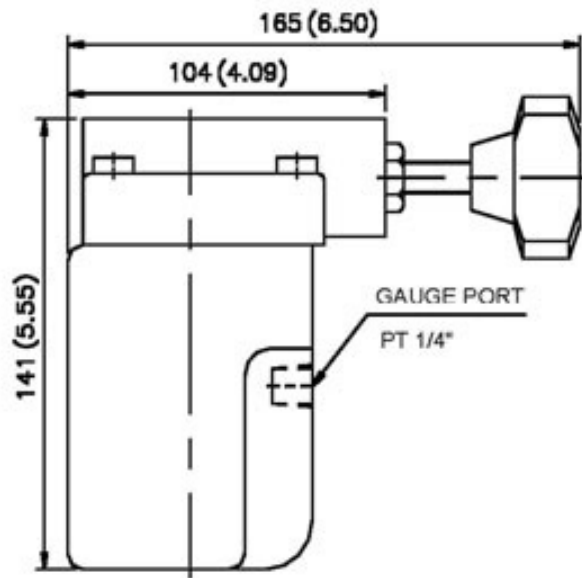

RFG-06/10

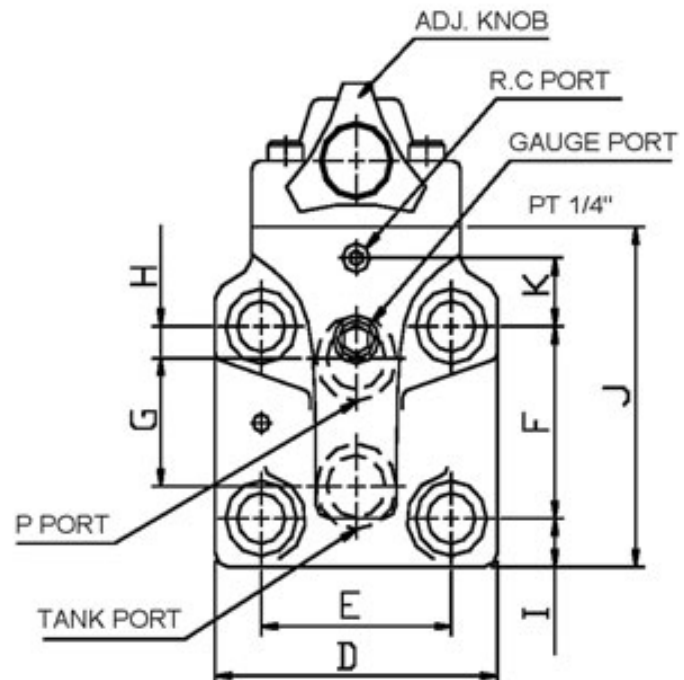
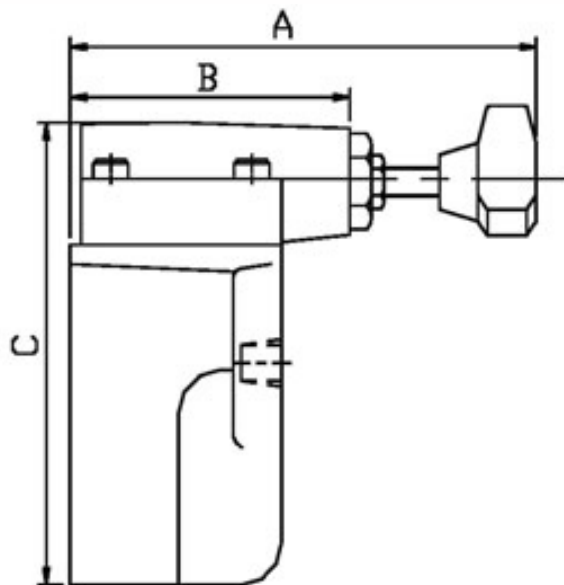

MODEL	A	B	C	D	E	F	G	H	I	J	K	WEIGHT	
												KGS	LBS
RF-G06	175 (6.89)	104 (4.09)	160 (6.30)	104 (4.09)	70 (2.76)	66.6 (2.62)	44.1 (1.74)	11.1 (1.74)	19.5 (0.76)	122 (4.80)	23.8 (0.94)	6.7	14.7
RF-G10	184 (7.24)	120 (4.72)	195 (7.68)	125 (4.92)	82 (3.23)	88.9 (3.50)	63.6 (2.50)	12.7 (0.50)	18.5 (0.73)	150 (5.91)	31.8 (1.25)	10.1	22.1

PILOT OPERATED RELIEF VALVE
RF SERIES

DIMENSIONS

UNIT: mm(inch) WEIGHT: 1.5 kgs(3.4 lbs)

RF-T*

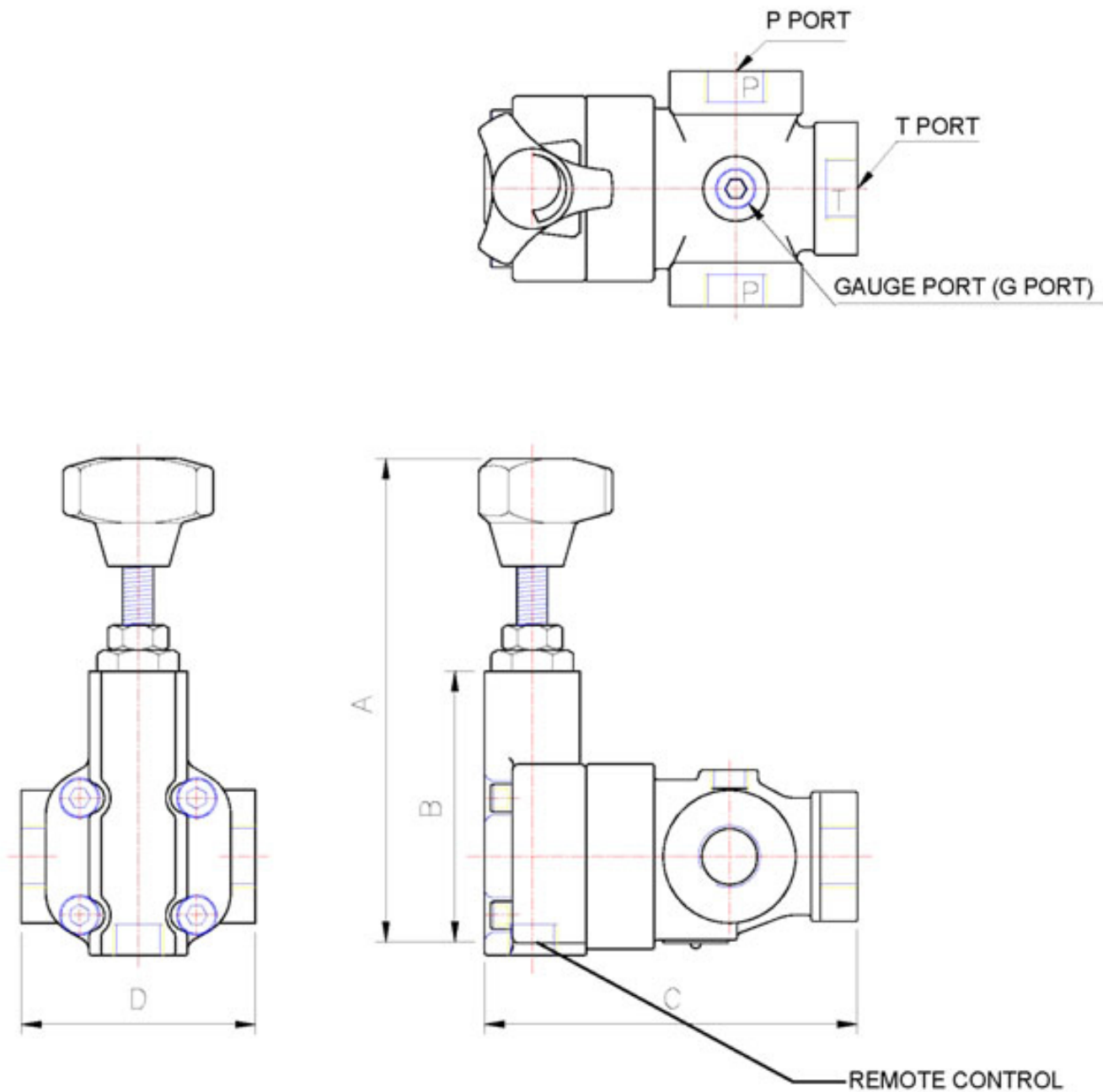

MODEL	A	B	C	D	P PORT	T PORT	G PORT	WEIGHT	
								KGS	LBS
RF-T04 SERIES	MAX. 142 (5.59)	92 (3.62)	111 (4.37)	84.5 (3.33)	PT 1/2"	PT 1/2"	PT 1/4"	3.4	7.5
RF-T06 SERIES	MAX. 148 (5.83)	102 (4.02)	140 (5.51)	103 (4.05)	PT 3/4"	PT 3/4"	PT 1/4"	5.3	11.7
RF-T10 SERIES	151 MAX. (5.94)	120 (4.72)	183 (7.20)	120 (4.72)	PT 1-1/4"	PT 1-1/4"	PT 1/4"	8.5	18.7