

## 84AFF NON ADJUSTABLE FIXED ORIFICE VALVE INSTALLATION & USER GUIDE

### **SPECIFICATIONS:**

- Orifice DIA. 0 – 0.250" (0 – 0.635 cm).
- Rated for 3000 psi (207 bar).
- Weighs 1/4 lb. (0.11 kg).
- 30-Micron Filtration Recommended.
- Port size #8 SAE (3/4-16).

### **FREQUENTLY ASKED QUESTIONS:**

**Q:** Can I change the fixed orifice in my valve?

**A:** The fixed orifice can be changed within the valve to an orifice with a smaller or larger diameter.

### **DIMENSIONAL DATA:**

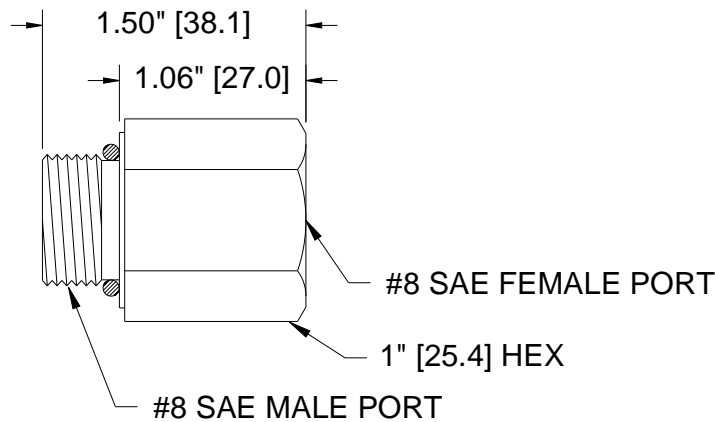

### **SAFETY PRECAUTIONS**

- It is the purchaser's responsibility to determine the suitability of any Brand Hydraulics Co. product for an intended application, and to ensure that it is installed in accordance with all federal, state, local, private safety and health regulations, codes and standards. Due to the unlimited variety of machines, vehicles and equipment on which our products can be used, it is impossible for Brand Hydraulics Co. to offer expert advice on the suitability of a product for a specific application. It is our customer's responsibility to undertake the appropriate precautions, testing and evaluation to prevent injury to the end-user.