

A M E R I C A N   W E T   T A N K   S Y S T E M S

**AMERICAN**



**MOBILE POWER**

SIDE MOUNT RESERVOIRS

get the  
**WET TANK**

**Solution**



**Vol. 9**

**1-800-634-8265**

[www.americanmobilepower.com](http://www.americanmobilepower.com)





# WARRANTY

The American Wet Tank System is warranted to be free of defects in material or workmanship and to meet American Mobile Power's written specifications at the time of sale. American's obligation and liability under this warranty is expressly limited to repairing or replacing, at American's option, within one year after date of original installation any defective part or parts or any product not meeting the specifications.

**This warranty is in lieu of all other warranties, express or implied. American makes no warranty of merchant ability or of fitness for any particular purpose. American's obligation under this warranty shall not include any transportation charges or costs of installation of any liability for direct, indirect, special, incidental, or consequential damages or delay. The remedies set forth herein are exclusive, and American's liability with respect to any contract or sale or anything done in connection therewith, whether in contract, in tort, under any warranty, or otherwise, shall not, except as expressly provided herein, exceed the price of the product or part on which such liability is based.**

If requested by American, products or parts for which a warranty claim is made are to be returned transportation prepaid to a Service Center designated by American. Any installation or use not in accordance with the catalog or package instructions, other improper use, operation beyond an intermittent duty, substitution of parts not approved by American, use with equipment other than the equipment on which the Wet Tank System is first installed, or alteration or repair made to the unit other than at an American designated Service Facility, shall void this warranty.



## WARNING:

IMPROPER SELECTION OR IMPROPER USE OF THE PRODUCTS AND/OR SYSTEMS DESCRIBED HEREIN OR RELATED ITEMS CAN CAUSE DEATH, PERSONAL INJURY AND PROPERTY DAMAGE.

This document and other information from American Mobile Power and authorized distributors provide this product and/or system options for further investigation by users having technical expertise. It is important that you analyze all aspects of your application and review the information concerning the product or system in the current product catalog. Due to the variety of operating conditions and applications for these products or systems, the user, through its own analysis and testing, is solely responsible for making the final selection of the products and systems and assuring that all performance, safety and warning requirements of the application are met. The products described herein, including without limitation, product features and specifications. Designs are subject to change by American Mobile Power at any time without notice.



## Model A3107

Steel Sidemount - 7 Gallon

Tank Size: 12" long x 12" wide x 12" high

Shipping Weight: 40#

Steel tank assembly, fully baffled, with 2" x 2" x 6" mounting angles. Two 1-1/4" NPT suction ports; two 1" return line ports; magnetic drain plug; one 1-1/4" port plug and one 1" port plug. Powder coated black. Filler/breather assembly - including 40 micron filter/breather cap (chain mounted) with nylon strainer basket and bayonet closure. Oil level and temperature indicator. Unit is packaged in one carton and shipped UPS.

CHANGES MAY BE MADE TO PRODUCT WITHOUT NOTICE.

TO SEE OUR FULL LINE OF DRAWINGS GO TO [WWW.AMERICANMOBILEPOWER.COM](http://WWW.AMERICANMOBILEPOWER.COM)

Order No.	Weight	Description	Page #
ASG-105	1#	Sight/Temperature Gauge	40
AFC-330	2#	Fill Assembly	38
ABC-315	1#	Filter/Breather Cap Only	39
APP-204	1#	Steel Port Plug - 1-1/4" NPT	41
APP-210-M	1#	Magnetic Port Plug - 3/4" NPT	41
APP-210	1#	Steel Port Plug - 1" NPT	41
ALL TANKS FACTORY TESTED			

# Model A3100

Steel Sidemount - 10 Gallon

Tank Size: 12" long x 14" wide x 14" high

Shipping Weight: 45#



Steel tank assembly, fully baffled, with pre-punched and slotted 2" x 2" mounting angles. Two 1-1/4" NPT suction ports; two 1" return line ports; magnetic drain plug; one 1-1/4" port plug and one 1" port plug. Powder coated black. Filler/breather assembly - including 40 micron filter/breather cap (chain mounted) with nylon strainer basket and bayonet closure. Oil level and temperature indicator. Unit is packaged in one carton and shipped UPS.

CHANGES MAY BE MADE TO PRODUCT WITHOUT NOTICE.  
TO SEE OUR FULL LINE OF DRAWINGS GO TO [WWW.AMERICANMOBILEPOWER.COM](http://WWW.AMERICANMOBILEPOWER.COM)

Order No.	Weight	Description	Page #
<b>ASG-105</b>	<b>1#</b>	<b>Sight/Temperature Gauge</b>	<b>40</b>
<b>AFC-330</b>	<b>2#</b>	<b>Fill Assembly</b>	<b>38</b>
<b>ABC-315</b>	<b>1#</b>	<b>Filter/Breather Cap Only</b>	<b>39</b>
<b>APP-204</b>	<b>1#</b>	<b>Steel Port Plug - 1-1/4" NPT</b>	<b>41</b>
<b>APP-210-M</b>	<b>1#</b>	<b>Magnetic Port Plug - 3/4" NPT</b>	<b>41</b>
<b>APP-210</b>	<b>1#</b>	<b>Steel Port Plug - 1" NPT</b>	<b>41</b>
ALL TANKS FACTORY TESTED			



## Model A3150

Steel Sidemount - 15 Gallon

Tank Size: 16" long x 14" wide x 16" high

Shipping Weight: 62#

Steel tank assembly, fully baffled, with pre-punched and slotted 2" x 2" mounting angles. Two 2" NPT suction ports; two 1-1/4" return line ports; magnetic drain plug; one 2" port plug and one 1-1/4" port plug. Powder coated black. Filler/breather assembly - including 40 micron filter/breather cap (chain mounted) with nylon strainer basket and bayonet closure. Oil level and temperature indicator. Unit is packaged in one carton and shipped UPS.

CHANGES MAY BE MADE TO PRODUCT WITHOUT NOTICE.

TO SEE OUR FULL LINE OF DRAWINGS GO TO [WWW.AMERICANMOBILEPOWER.COM](http://WWW.AMERICANMOBILEPOWER.COM)

Order No.	Weight	Description	Page #
ASG-105	1#	Sight/Temperature Gauge	40
AFC-330	2#	Fill Assembly	38
ABC-315	1#	Filter/Breather Cap Only	39
APP-204	1#	Steel Port Plug - 1-1/4" NPT	41
APP-210-M	1#	Magnetic Port Plug - 3/4" NPT	41
APP-220	1#	Steel Port Plug - 2" NPT	41
ALL TANKS FACTORY TESTED			

**OPTION:** Installed inspection port with 6" cover.

# Model A3250

Steel Sidemount - 25 Gallon

Tank Size: 20" long x 15" wide x 20" high

Shipping Weight: 84#



Steel tank assembly, fully baffled, with pre-punched and slotted 2" x 2" mounting angles. Two 2" NPT suction ports; two 1-1/4" return line ports; magnetic drain plug; one 2" port plug and one 1-1/4" port plug. Powder coated black. Filler/breather assembly - including 40 micron filter/breather cap (chain mounted) with nylon strainer basket and bayonet closure. Oil level and temperature indicator. Unit is packaged in one carton and shipped UPS.

CHANGES MAY BE MADE TO PRODUCT WITHOUT NOTICE.  
TO SEE OUR FULL LINE OF DRAWINGS GO TO [WWW.AMERICANMOBILEPOWER.COM](http://WWW.AMERICANMOBILEPOWER.COM)

Order No.	Weight	Description	Page #
<b>ASG-105</b>	<b>1#</b>	<b>Sight/Temperature Gauge</b>	<b>40</b>
<b>AFC-330</b>	<b>2#</b>	<b>Fill Assembly</b>	<b>38</b>
<b>ABC-315</b>	<b>1#</b>	<b>Filter/Breather Cap Only</b>	<b>39</b>
<b>APP-204</b>	<b>1#</b>	<b>Steel Port Plug - 1-1/4" NPT</b>	<b>41</b>
<b>APP-210-M</b>	<b>1#</b>	<b>Magnetic Port Plug - 3/4" NPT</b>	<b>41</b>
<b>APP-220</b>	<b>1#</b>	<b>Steel Port Plug - 2" NPT</b>	<b>41</b>
ALL TANKS FACTORY TESTED			

**OPTION:** Installed inspection port with 6" cover.



## Model A3300

Steel Sidemount - 30 Gallon

Tank Size: 24" long x 15" wide x 20" high

Shipping Weight: 98#

Steel tank assembly, fully baffled, with pre-punched and slotted 2" x 2" mounting angles. Two 2" NPT suction ports; two 1-1/4" return line ports; magnetic drain plug; one 2" port plug and one 1-1/4" port plug. Powder coated black. Filler/breather assembly - including 40 micron filter/breather cap (chain mounted) with nylon strainer basket and bayonet closure. Oil level and temperature indicator. Unit is packaged in one carton and shipped UPS.

CHANGES MAY BE MADE TO PRODUCT WITHOUT NOTICE.

TO SEE OUR FULL LINE OF DRAWINGS GO TO [WWW.AMERICANMOBILEPOWER.COM](http://WWW.AMERICANMOBILEPOWER.COM)

Order No.	Weight	Description	Page #
ASG-105	1#	Sight/Temperature Gauge	40
AFC-330	2#	Fill Assembly	38
ABC-315	1#	Filter/Breather Cap Only	39
APP-204	1#	Steel Port Plug - 1-1/4" NPT	41
APP-210-M	1#	Magnetic Port Plug - 3/4" NPT	41
APP-220	1#	Steel Port Plug - 2" NPT	41
ALL TANKS FACTORY TESTED			

**OPTION:** Installed inspection port with 6" cover.

# Model A3400

Steel Sidemount - 40 Gallon

Tank Size: 36" long x 12" wide x 20" high

Shipping Weight: 126#



Steel tank assembly, fully baffled, with pre-punched and slotted 2" x 2" mounting angles. Two 2" NPT suction ports; two 1-1/4" return line ports; magnetic drain plug; one 2" port plug and one 1-1/4" port plug. Powder coated black. Filler/breather assembly - including 40 micron filter/breather cap (chain mounted) with nylon strainer basket and bayonet closure. Oil level and temperature indicator. Unit is packaged in one carton and shipped UPS.

CHANGES MAY BE MADE TO PRODUCT WITHOUT NOTICE.  
TO SEE OUR FULL LINE OF DRAWINGS GO TO [WWW.AMERICANMOBILEPOWER.COM](http://WWW.AMERICANMOBILEPOWER.COM)

Order No.	Weight	Description	Page #
ASG-105	1#	Sight/Temperature Gauge	40
AFC-330	2#	Fill Assembly	38
ABC-315	1#	Filter/Breather Cap Only	39
APP-204	1#	Steel Port Plug - 1-1/4" NPT	41
APP-210-M	1#	Magnetic Port Plug - 3/4" NPT	41
APP-220	1#	Steel Port Plug - 2" NPT	41
ALL TANKS FACTORY TESTED			

**OPTION:** Installed inspection port with 6" cover.





## Model A4150

Aluminum Sidemount - 15 Gallon

Tank Size: 16" long x 14" wide x 16" high

Shipping Weight: 31#

Aluminum tank assembly constructed of Bright Diamond Plate and bright mill finish, fully baffled, with 2" x 2" mounting angles. Two heavy duty, machined 2" NPT suction ports; two heavy duty machined 1-1/4" return line ports; magnetic drain plug; one 2" port plug and one 1-1/4" port plug. Filler/Breather assembly - including 40 micron filter/breather cap (chain mounted) with nylon strainer basket and bayonet closure. Oil level and temperature indicator. Unit is packaged in one carton and shipped UPS.

CHANGES MAY BE MADE TO PRODUCT WITHOUT NOTICE.

TO SEE OUR FULL LINE OF DRAWINGS GO TO [WWW.AMERICANMOBILEPOWER.COM](http://WWW.AMERICANMOBILEPOWER.COM)

Order No.	Weight	Description	Page #
ASG-105	1#	Sight/Temperature Gauge	40
APP-204	1#	Steel Port Plug - 1-1/4" NPT	41
APP-220	1#	Steel Port Plug - 2" NPT	41
ABC-315	1#	Filter/Breather Cap Only	39
APP-210-M	1#	Magnetic Port Plug - 3/4" NPT	41
AFC-330	2#	Fill Assembly	38
ALL TANKS FACTORY TESTED			

**OPTION:** Installed inspection port with 6" cover.

# Specialty Hydraulic Tanks

## Model A330SL

Specialty Hydraulic Tank: 30 Gallon

Tank Size: 15" long x 19" wide x 25" high

Shipping Weight: 96#

Steel tank assembly, fully baffled, with pre-punched and slotted 2" x 2" mounting angles. Angles are rear mounted with an extra (2) pre-punched and slotted 2" x 2" angles (shipped loose) for adjustable mounting with your specific application. One 2" NPT suction port; one 1-1/4" return line port. Filter/breather assembly - including 40 micron filter/breather cap (chain mounted) with nylon strainer and bayonet closure. Oil level and temperature indicator gauge. Unit is packaged in one carton and shipped UPS.

Also available in 20 and 25 gallon.

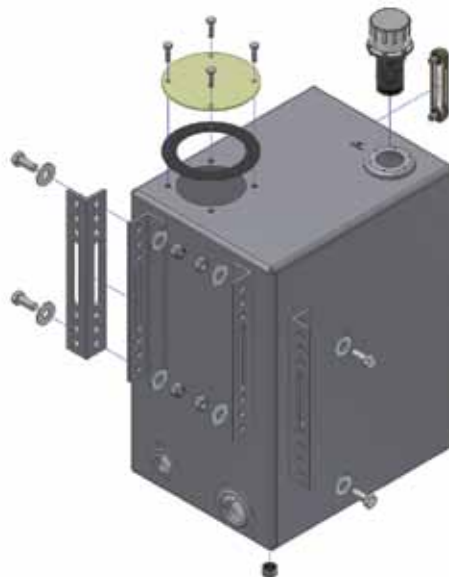

STEEL POLYETHYLENE ALUMINUM STEEL POLYETHYLENE ALUMINUM STEEL

STEEL POLYETHYLENE ALUMINUM STEEL POLYETHYLENE ALUMINUM STEEL POLYETHYLENE ALUMINUM STEEL POLYETHYLENE ALUMINUM STEEL

STEEL POLYETHYLENE ALUMINUM STEEL POLYETHYLENE ALUMINUM STEEL POLYETHYLENE ALUMINUM STEEL POLYETHYLENE ALUMINUM STEEL

A3150



A3250



A3300



A3400



A3000



A3070



A4000

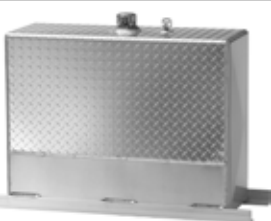

A2000



A4070



A3525



A4525



A4150



A3535



A4535



A3500



A4500



A3575



A4575



• CALL TODAY •

• WE SHIP •

JUST IN TIME!

**1-800-634-8265**

STEEL POLYETHYLENE ALUMINUM STEEL POLYETHYLENE ALUMINUM STEEL